

Benjamin Davis

John Brand

Jeremiah Williamson

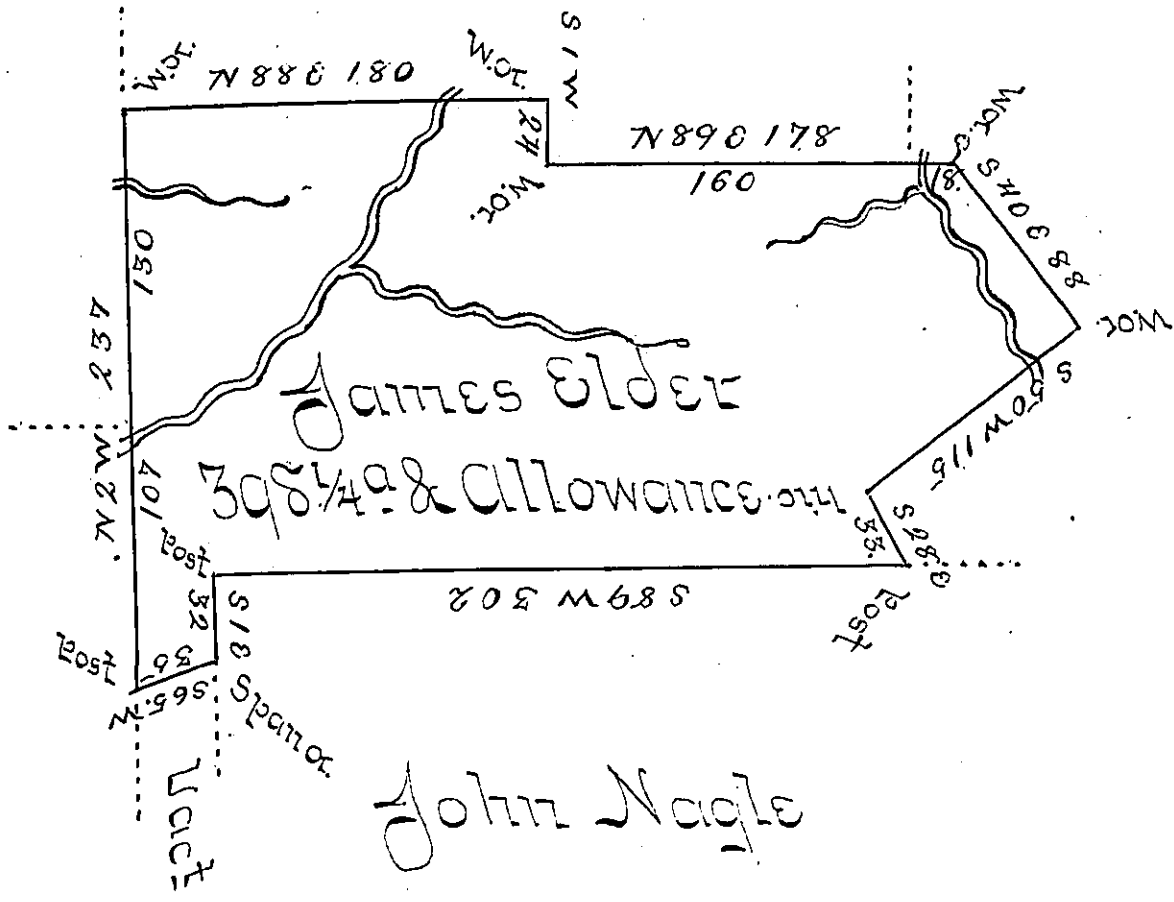

Vacant Land

John Nagle

Survey'd to James Elder on the 1st March 1789. The above described Tract of Three Hundred and ninety eight acres and one fourth of an acre and Allowance of six Percent. Situate on the waters of Two Lick Creek adjoining John Nagle and Jeremiah Williamson in Armstrong Township Westmoreland County, By Warrant of the 20th day of January 1789

John Lukens Esq^r S. Gen^l

Josiah Elder D.S.

IN TESTIMONY that the above is a copy of the original remaining on file in the Department of Internal Affairs of Pennsylvania, made conformably to an Act of Assembly approved the 16th day of February, 1833, I have hereunto set my Hand and caused the Seal of said Department to be affixed at Harrisburg, this — Second — day of — September — 1902. —

James W. Little
 Secretary of Internal Affairs.